

# ROLLENKETTEN NACH METEOR-NORM

ROLLER CHAINS DUE TO METEOR STANDARD

## ROLLENKETTEN VERSTÄRKT

ROLLER CHAINS REINFORCED

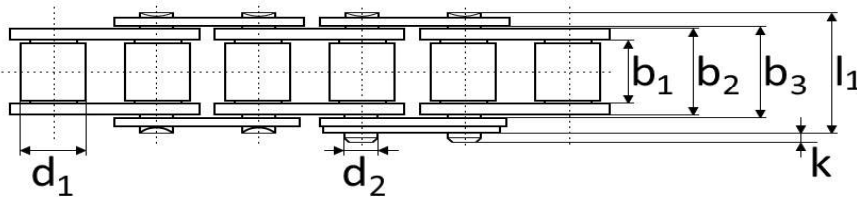

Teilung	<b>p</b>	Pitch
Innere Breite	<b>b<sub>1 min</sub></b>	Inside width
Rollen Ø	<b>d<sub>1 max</sub></b>	Roller Ø
Bolzen Ø	<b>d<sub>2 max</sub></b>	Pin Ø
Bruchkraft	<b>F<sub>B</sub></b>	Breaking load
Meßkraft	<b>N</b>	Measured strength
Gelenkfläche	<b>f</b>	Link surface
Gewicht	<b>q</b>	Weight
Verbindungsglieder	<b>VGL</b>	Links

	ISO Nr. ISO No.	p x b <sub>1</sub>	p mm	b <sub>1 min</sub> mm	d <sub>1 min</sub> mm	d <sub>2 min</sub> mm	b <sub>2 max</sub> mm	g <sub>max</sub> mm	e mm	l <sub>1 max</sub> mm	k <sub>max</sub> mm	N <sub>min</sub>	f cm <sup>2</sup>	q kg/m	VGL			
															S	C	E	L
<b>SIMPLEX</b>	VK 4	<sup>3</sup> / <sub>4</sub> x <sup>7</sup> / <sub>16</sub> "	19,05	11,68	12,07	6,1	17,23	18,0	-	25,9	2,2	40	1,05	1,6	x	-	x	x

Innenglied  
Inside link

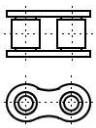

**B**

Außenglied  
Outside link

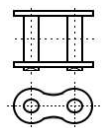

**A**

Verbindungsglied mit Feder  
Connecting link with spring clip

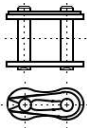

**E**

Laufrichtung  
Running direction

Verbindungsglied mit Splinten  
Connecting link with splint pins

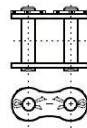

**S**

Gekröpftes Glied mit Splint  
Cranked link with splint pin

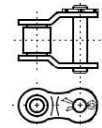

**L**

Gekröpftes Doppelglied  
Cranked double link

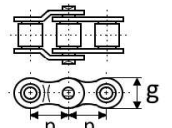

**C**

## ROLLENKETTEN MIT GERADEN LASCHEN

ROLLER CHAINS WITH STRAIGHT SIDE PLATES

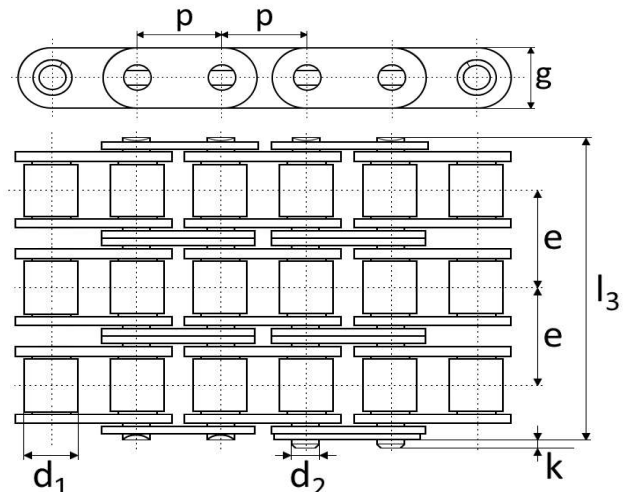
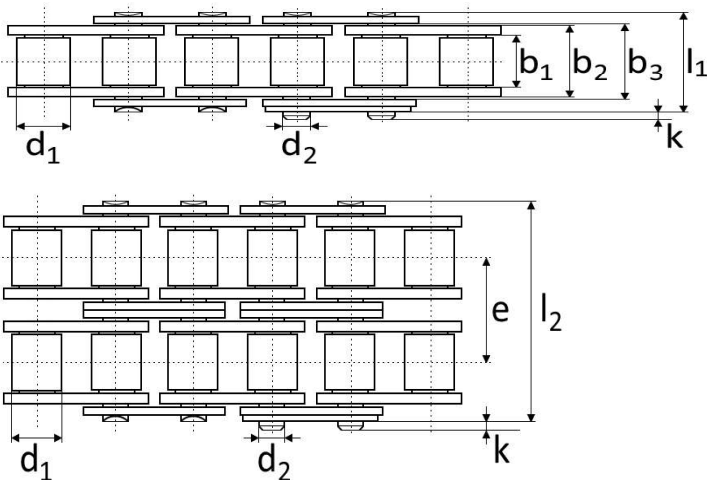

	ISO Nr. ISO No.	p x b <sub>1</sub>	p mm	b <sub>1 min</sub> mm	d <sub>1 min</sub> mm	d <sub>2 min</sub> mm	b <sub>2 max</sub> mm	g <sub>max</sub> mm	e mm	l <sub>1 max</sub> mm	k <sub>max</sub> mm	N <sub>min</sub>	f cm <sup>2</sup>	q kg/m	VGL			
															S	C	E	L
<b>SIMPLEX</b>	*16GK24-1	1" x 17,02 mm	25,4	17,02	15,88	8,28	25,4	24,0	-	36,1	5,4	60,0	2,1	3,14	x		x	
<b>DUPLEX</b>	*16GK24-2	1" x 17,02 mm	25,4	17,02	15,88	8,28	25,4	24,0	31,88	68,0	5,4	106,0	4,21	8,5	x		x	
<b>TRIPLEX</b>	*16GK24-3	1" x 17,02 mm	25,4	17,02	15,88	8,28	25,4	24,0	31,88	99,9	5,4	160,0	6,31	11,0	x		x	

\* Laschenhöhe von DIN 8187 abweichend  
Plate height deviating from DIN 8187

Innenglied  
Inside link

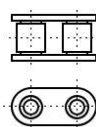

**B**

Außenglied  
Outside link

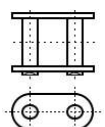

**A**

Verbindungsglied mit Feder  
Connecting link with spring clip

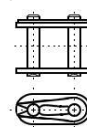

**E**

Laufrichtung  
Running direction

Verbindungsglied mit Splinten  
Connecting link with splint pins

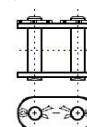

**S**

Gekröpftes Glied mit Splint  
Cranked link with splint pin

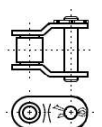

**L**

Gekröpftes Doppelglied  
Cranked double link

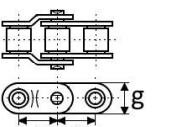

**C**